

GUM-TECH PUZZLE 3D GYM ALL-ROUNDER

Our latest product development - interconnectable 3D gym floors

Gum-tech Puzzle 3D gym all-rounders are new product types in our Fitnessgum product series. Feedback from our customers in recent years has convinced us to go new ways and develop a tile which is easier to install, prevents tile slippage and does not require gluing.

Problems of floor protection so far

Rubber tiles usually supplied with connectors or plastic dowels are one of the most common protective floorings for gyms and sports facilities. The advantage of this solution is that the links established via the connectors hold the tiles together without any need for gluing. The biggest drawbacks of this method are the high expenditure in terms of work, and the potential fault sources. If connectors are forgotten, or intervals cannot be exactly maintained, the plates might slide. Such faults are not only visually detrimental but also dangerous for athletes. Coverings with dimensions of less than 3 cm are usually delivered without connectors and must be glued. Although adhesive solutions ensure surface stability, they require many hours of work and involve high costs of the adhesive itself.

The 3D solution

Gum-tech's Puzzle 3D gym all-rounders offer a new type of solution here. The puzzle elements can be simply connected to result in a precisely predefined joint width. Puzzle links alone would not solve the problems already described. For this reason, our technicians have developed 3D intermediate elements so that the tiles are connected not only horizontally, but also vertically.

The developed 3D intermediate elements and typical connection elements of the puzzle together form a unit. Additional interlocking stabilizes this unit. Knobs installed on the positive connection elements form a link here with indentations on the negative connection elements. With regard to the previously described problems with conventional tiles, no faults creep in during installation in this case. The intervals are automatically identical, and plug-type connectors are not required.

Even intensive movements during workouts at the fitness centre do not pull apart Gum-tech's Puzzle 3D gym all-rounders. Because the work can also be carried out faster, and gluing of the tiles is not necessary, costs for the customer are lowered. Gum-tech's Puzzle 3D gym all-rounders are based on Gum-tech's proven basic materials.

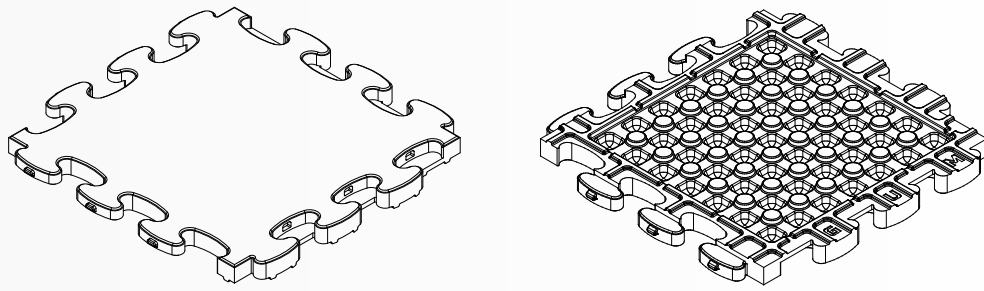

Drawing 1

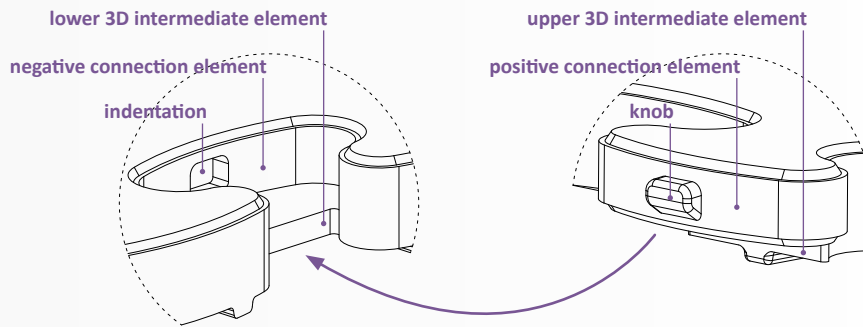

Drawing 2

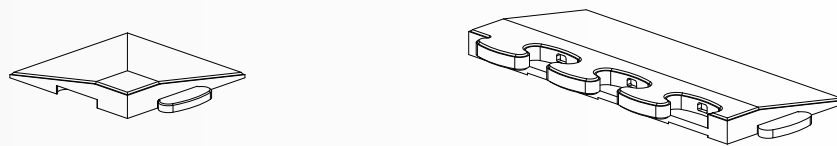

Drawing 3

INSTALLATION GUIDE

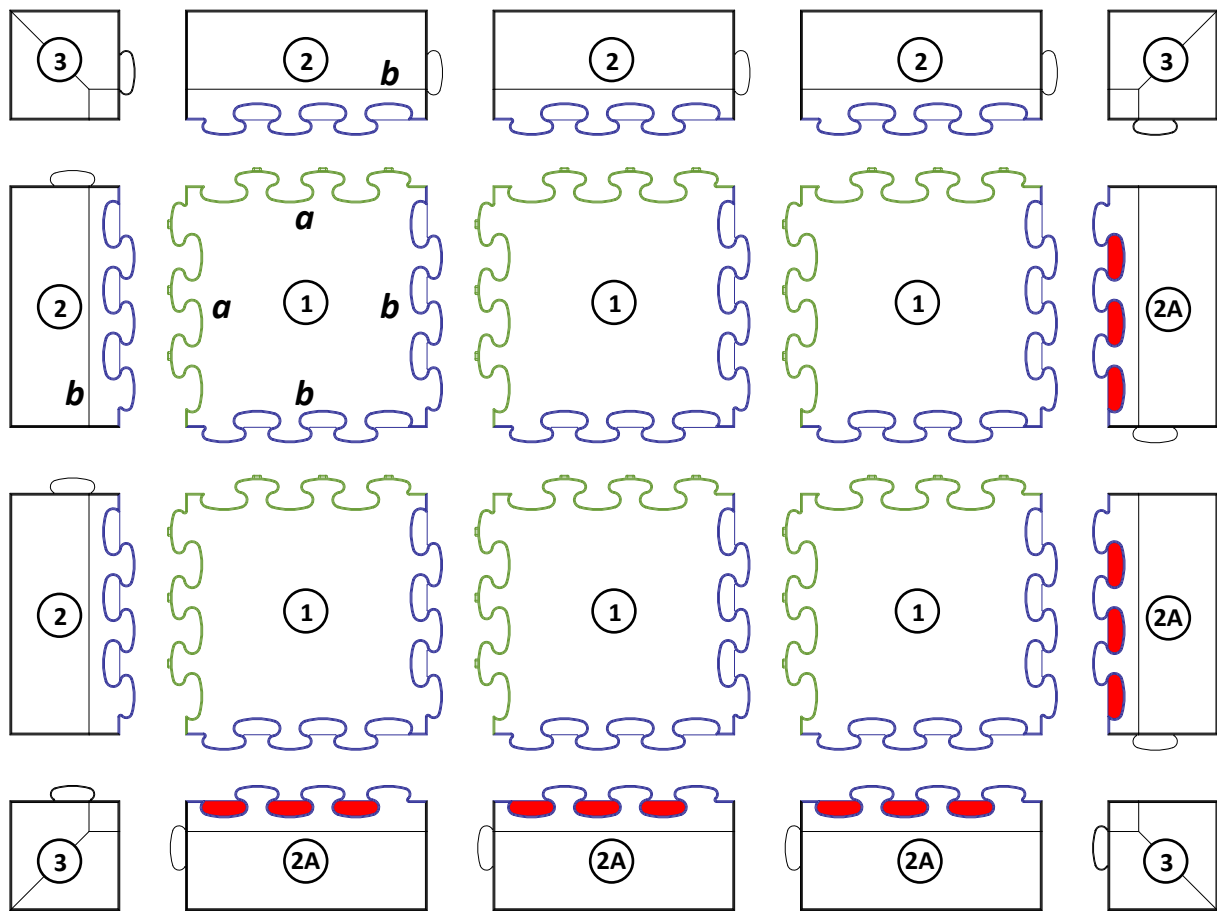

- Laying of the tiles starts with fitting together the corner tiles marked '3' and the border tiles marked '2'.
- In the next step, the tiles marked '1' are fitted together. The different sides are a decisive factor here. We have indicated sides with identical characteristics respectively in green (letter "a") and blue (letter "b"). The different sides are fit together in each case. The positive connection elements are linked to the negative connection elements here.
- After the pieces of the puzzle have been connected together, the surface must be closed by means of border and corner tiles (see 2, 2A, 3). More information about this topic and removal of the 3D intermediate elements is provided next.

REMOVAL OF 3D INTERMEDIATE ELEMENTS

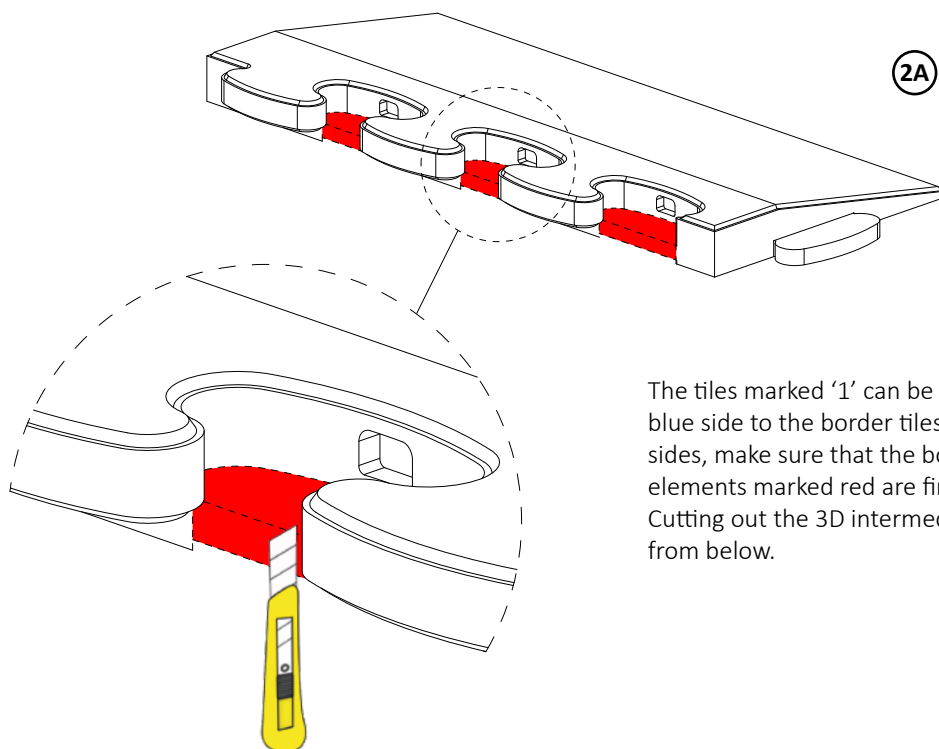

The tiles marked '1' can be linked via their green or blue side to the border tiles. When fitting the blue sides, make sure that the border tiles' 3D intermediate elements marked red are first cut out with a utility knife. Cutting out the 3D intermediate elements is easiest from below.

DIMENSIONS

Dimensions of 62 x 62 cm should be planned for during loading of gym all-rounders on pallets. During laying, dimensions of 55 x 55 cm should be planned for. A value of 0.3025 m² can be used for calculating areas. If no cutting is planned, it is advisable to take into account the width of the border and corner tiles.

